

**T60-T**

Sealed Toggle Switches



FEATURE

1. Completely sealed switching chamber
2. Step-design case provides added space between terminals to help prevent shorting
3. IP68 protection degree



SPECIFICATIONS

CONTACT RATING: 15 GPA, 125 V AC, 250 V AC, 277 V AC

ELECTRIC LIFE: 10,000 cycles

CONTACT RESISTANCE: 10 mΩ max. (initial)

INSULATION RESISTANCE: 1,000 MΩ min. 500VDC

DIELECTRIC STRENGTH: 2,500 VAC/ 1 min.

OPERATING TEMPERATURE: -40°C to +85°C

How do you build the switches you need!!

T 6 0 1 3 - - T 1 E B - 1 0 - - H

Switch Function	
T6013	On-None-On
T6013A	On-None-(On)
T6014	On-Off-On
T6014A	(On)-Off-(On)
T6014B	On-Off-(On)

Locking	
/	NO Locking
A	in 3 position
D	out of center
G	keyway side

Actuator	
T1	Round
U1	Flatted

Bushing	
E	Standard

Terminal	
B	solder lug
D	quick connect
S	screw

Contact Material	
NON	No plated
Q	Silver plated

Agency approval	
/	none
10	10A UL
15	15A UL

Agency approval	
/	Standard
2P	Two terminal

RoHS code	
H=	ROHS Compliant

Model No.	Switching position		
T6013	ON	None	ON
T6013A	ON	None	(ON)
T6014	ON	OFF	ON
T6014A	(ON)	OFF	(ON)
T6014B	ON	OFF	(ON)

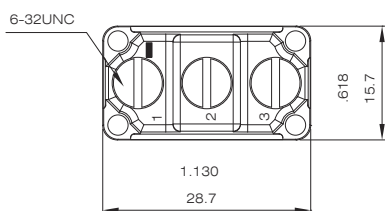
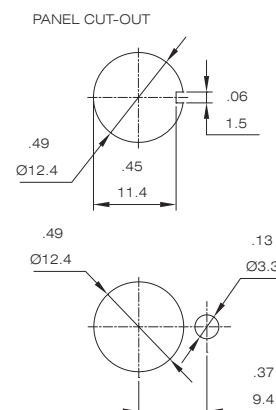
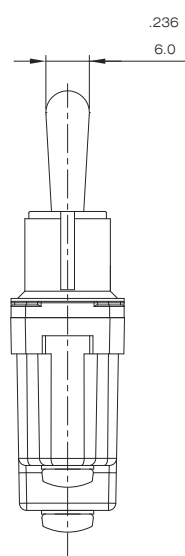
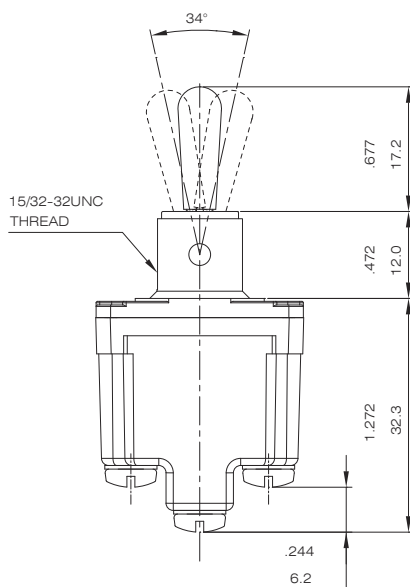

T6014 - T1ES - 15 - H