





SPDT



Model No.	Switching position	
L8601	on	on
L8603	on	mom
Term. Comm.	2-3	2-1

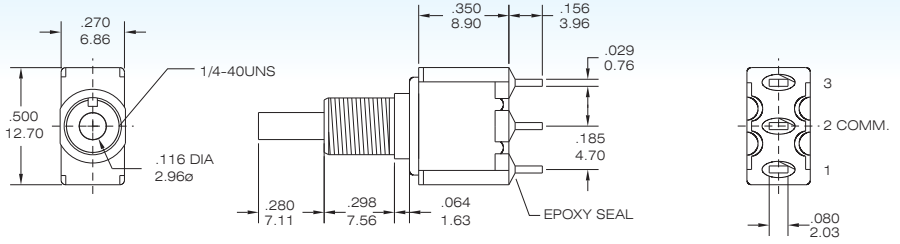
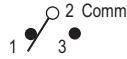

L8601-EBR-E

SPDT



Model No.	Switching position	
L8601P	on	on
L8603P	on	mom
Term. Comm.	2-3	2-1

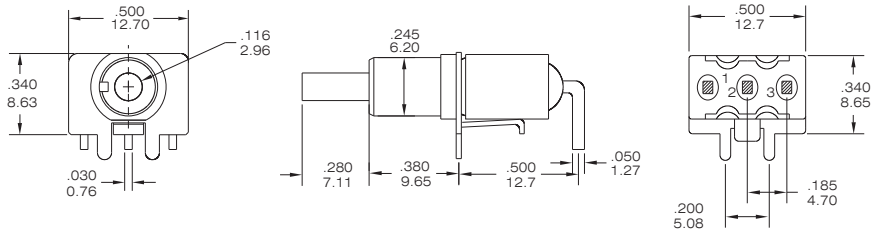

L8601P-MR-E

SPDT



Model No.	Switching position	
L8601L	on	on
L8603L	on	mom
Term. Comm.	2-3	2-1

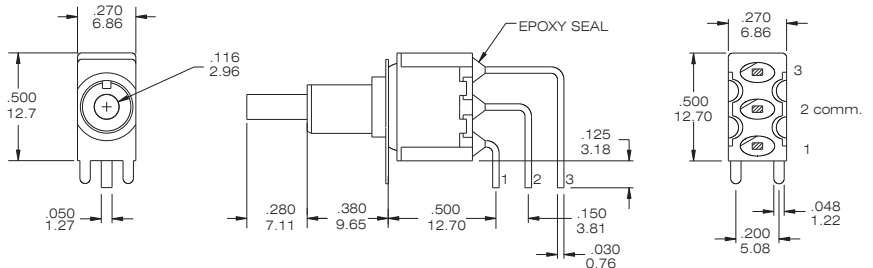
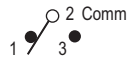

L8601L-MR-E

DPDT



Model No.	Switching position	
L8602	on	on
Term. Comm.	2-3 5-6	2-1 5-4

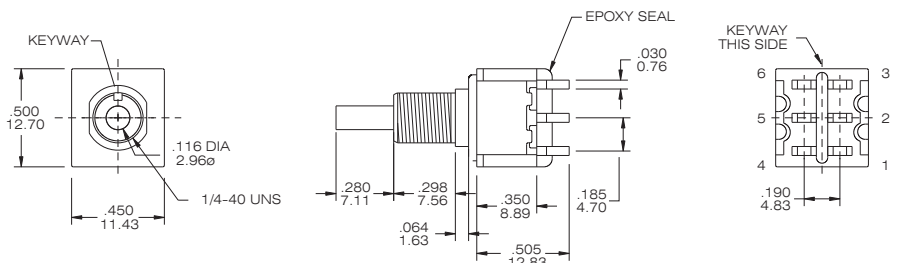

L8602-EBR-E

DPDT



Model No.	Switching position	
L8602P	on	on
Term. Comm.	2-3 5-6	2-1 5-4

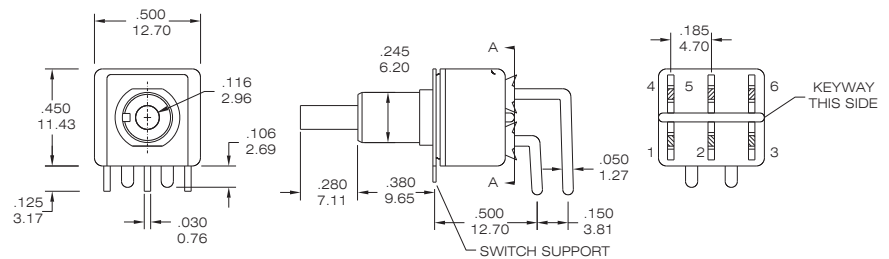

L8602P-MR-E

DPDT



Model No.	Switching position	
L8602L	on	on
Term. Comm.	2-3 5-6	2-1 5-4

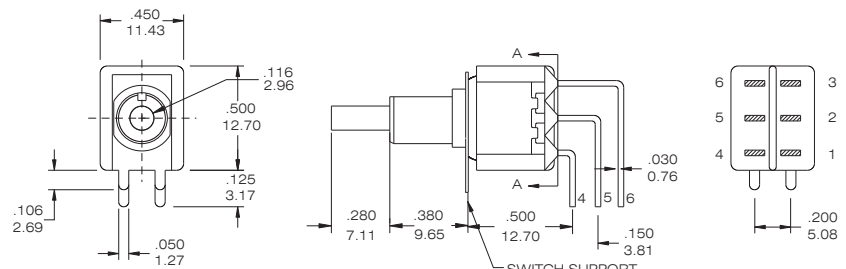

L8602L-MR-E

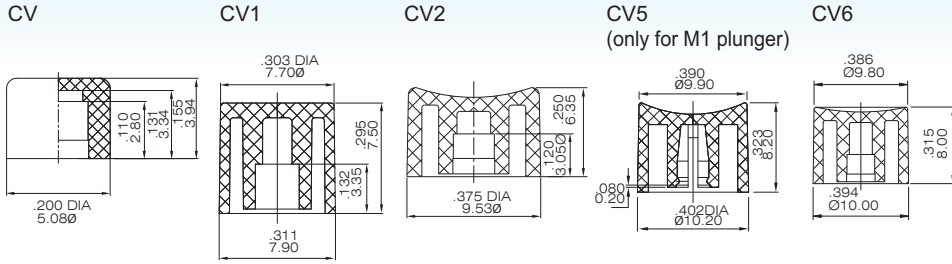
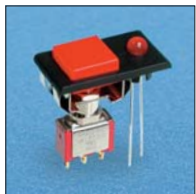
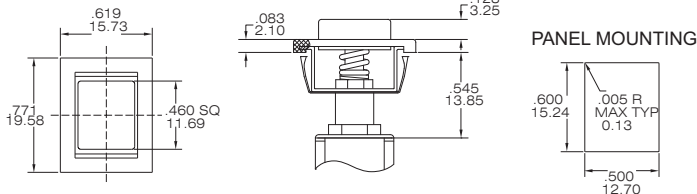
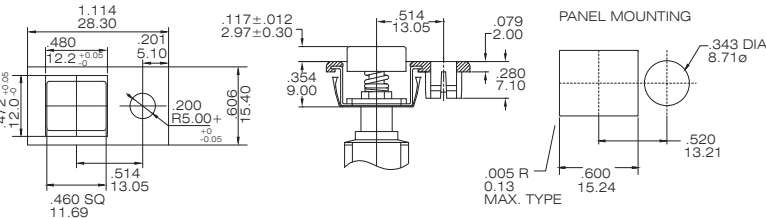
**T80-L****Alternate Action and Momentary Pushbutton Switches****Cap and Actuator Option****F22A****F32A****L860 * -F22A- * -BR-E****L860 * -F32A- * -BR-E****CAP & ACTUATOR OPTIONS**

1	White
2	Black(Std.)
3	Red
4	Orange
5	Yellow
6	Green
7	Blue
9	Gray

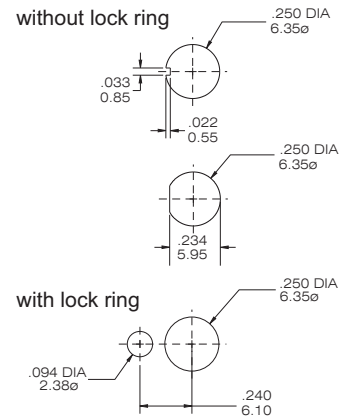
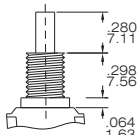
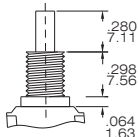
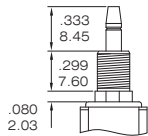
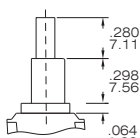
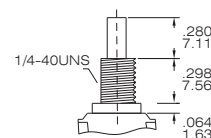
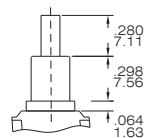
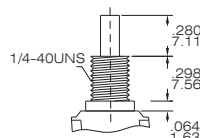
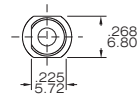
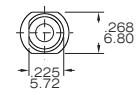
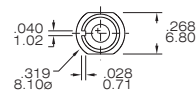
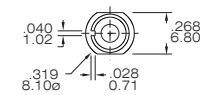
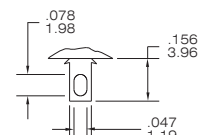
Panel Mounting**Plunger Option****(none) STD.**Plunger material:
Glass filled nylon or
glass filled polyester.**M**Plunger material:
Brass, chrome plated.**M1 Snap - fitting**Plunger material:
Brass, chrome plated.**Bushing Option****E****M****F****N****TERMINAL OPTION (ONLY FOR THE STRAIGHT TYPE L8601~L8602)****B SOLDER LUG**

THK 0.76 (.030)

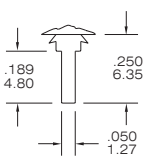
C PRINTED CIRCUIT

THK 0.76 (.030)

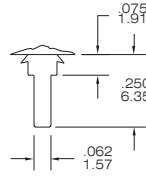
D QUICK CONNECT

THK 0.76 (.030)

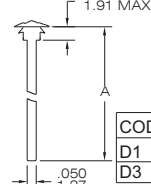
WIREWRAP

THK 0.76 (.030)

CODE	"A" dimension
D1	.750 (19.05)
D3	.425 (10.8)

TERMINAL SEAL OPTION**E TERMINAL SEAL**

EPOXY SEAL

CONTACT MATERIAL OPTIONS

CODE	CONTACT MATERIAL	TERMINAL MATERIAL	RATING
Q	Silver plated	Silver plated	6A @ 125VAC or 28 VDC ; 3A @ 250 VAC
R	Gold plated over nickel plated	Gold plated over nickel plated	0.4 VA MAX @ 20VAC or DC MAX
G	Gold plated over silver plated	Gold plated over silver plated	0.4 VA MAX @ 20 VAC or DC MAX or 6A @ 125VAC or 28 VDC ; 3A @ 250 VAC

VERTICAL SUPPORT BRACKET OPTION

(only apply the straight type terminal . Please choose the terminal option in "c" code)

S20 / S25 / V20 / V25



option Code	A dimension
S20/V20	.460 11.68
S25/V25	.630 16.00
V20/V25: the snap-in type	

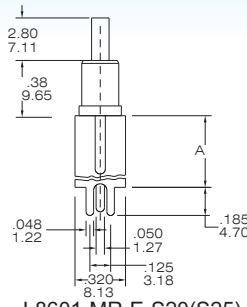
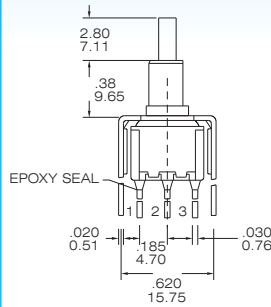

P.C. MOUNTING

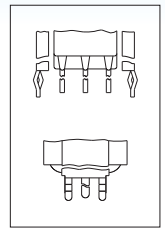
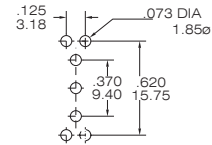

SNAP-IN
V20/ V25

L8601-MR-E-S20(S25)

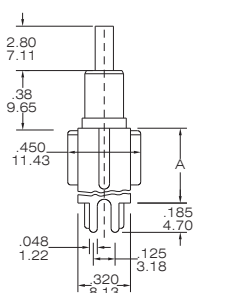
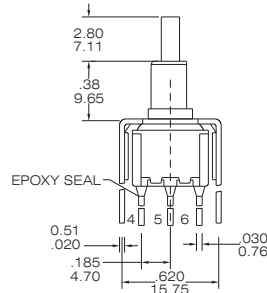

P.C. MOUNTING

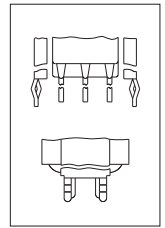
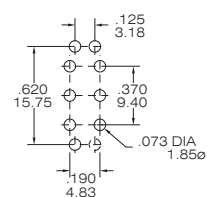

SNAP-IN
V20/ V25

L8602-MR-E-S20(S25)

S35 / S40 / V35 / V40



option Code	A dimension
S35/V35	.460 11.68
S40/V40	.630 16.00
V35/V40 : the snap-in type	

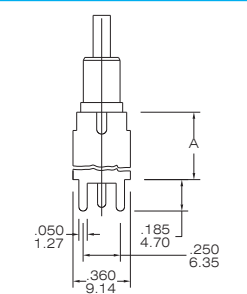
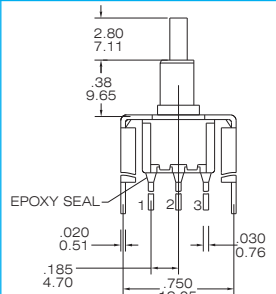

P.C. MOUNTING

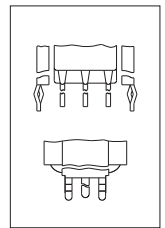
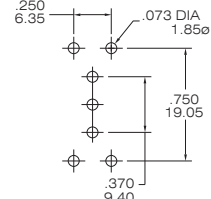

SNAP-IN
V35/ V40

L8601-MR-E-S35(S40)

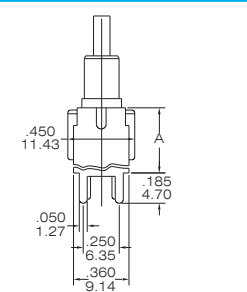
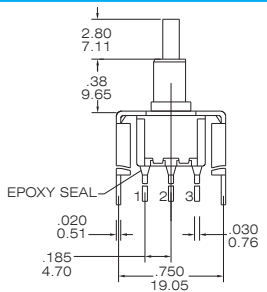

P.C. MOUNTING

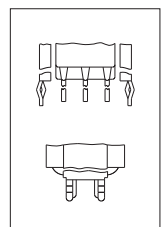
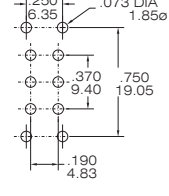

SNAP-IN
V35/ V40

L8602-MR-E-S35(S40)

The P.C.B mounting Dimensions

L8601P

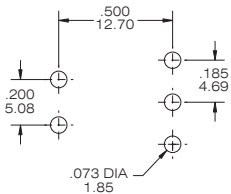

L8602P

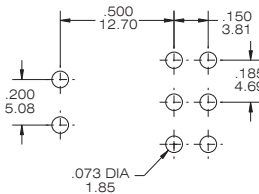

L8601L

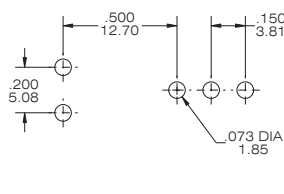

L8602L

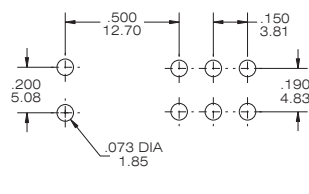

The hard ware of T80-L push button switches

STD.

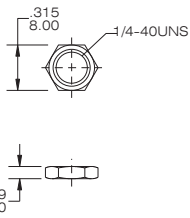

DRESS NUT

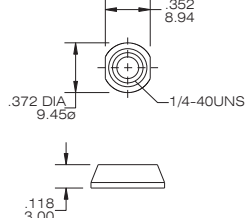

STD.

