

MPB22 Series

22mm Metal Pushbutton Switches



SPECIFICATIONS

RATING : lth 5A/250VAC resistive load 3A/250VAC
CONTACT RESISTANCE : 50 mΩ max. @ 1A 12VDC (initial value)
INSULATION RESISTANCE : 1,000 MΩ min. at 500VDC
DIELECTRIC STRENGTH : 2,000V RMS @ sea level
OPERATION TEMPERATURE : -20°C to 55°C
MECHANICAL LIFE : Momentary 1,000,000 cycles
Self-lock 500,000 cycles
ELECTRICAL LIFE : 50,000 make-and-break cycles at full load
TORQUE : 5~14Nm
PANEL THICKNESS : 10mm (Ø22.20mm)
OPERATION PRESSURE : 1Pole 2.5±1N / 2Poles 3.5±1N
TRAVEL : About 3.2mm
INGRESS PROTECTION : IP67, IK10(Stainless)

MATERIALS

BUSHING : Stainless Steel / Aluminum alloy
BASE : PBT(UL 94-V0) , PC(UL 94-V2)
ACTUATOR : PC; Stainless Steel / Aluminum alloy
INNER ASSEMBLY : POM / PA66.
SPRING : Spring steel.
SEALING : Silicone.
O-Ring : Silicone.
TERMINAL : Brass,with silver or gold plated.
CONTACT :
Q=Copper ,Silver plated.
R=Brass,Coin silver,Gold plated
HEX NUT : Nickel plated brass

HOW TO ORDER

MODEL NO. BODY TYPE BUTTON TYPE CONTACT CONFIGURATION OPERATING TYPE LIGHT TYPE LED COLOR LED VOLTAGE TERMINAL SHAPE TERMINAL PLATING

MPB22 — [] — [] — [] — [] — [] — [] — [] — [] — []

Body type
A0 Stainless (Natural)
C3 Al alloy (Black Anodized)

Button type
F Flat

Contact Configuration
1 1NO 1NC
2 2NO 2NC

Operating type
0 Momentary
1 Lock

Light type
0 Without LED
E Ring (Moveable)
E2 Illuminated Ring with led color ,red/green/blue availavle only

LED Color

ITEM NO	COLOR
0	Without LED
1	White
3	Red
5	Yellow
6	Green
7	Blue

DUAL COLOR LED

A	Red&Green
B	Red&Blue
D	Blue&Yellow
G	Red&Yellow
H	Green&Yellow
J	Orange&Green

LED Voltage (20mA)

ITEM NO	VOLTAGE
0	Without Resistor
3	3V
6	6V
12	12V
24	24V
36	36V
110	110V
220	220V

Terminal shape
J Solder terminal(std)
T1 Flying lead terminals L=500mm
T2 Flying lead terminals L=1000mm
T3 Flying lead terminals L=1500mm
T4 Flying lead terminals L=2000mm

Terminal plating
Q Silver
R Gold

MPB22 — [] — [] — [] — [] — [] — [] — [] — [] — []

Body type
D0 Stainless (Natural),Flat

Button type
F Flat

Contact Configuration
1 1NO 1NC
2 2NO 2NC

Operating type
0 Momentary
1 Lock

Light type
E1 Illuminated ring with power logo only availavle in white cap
E3 Illuminated ring with power logo with led color,red/green/blue availavle only

EXAMPLE:
MPB22-A0F100-JQ (Without LED)
MPB22-A0F10E- [] -JQ
LED color LED voltage

CIRCUIT

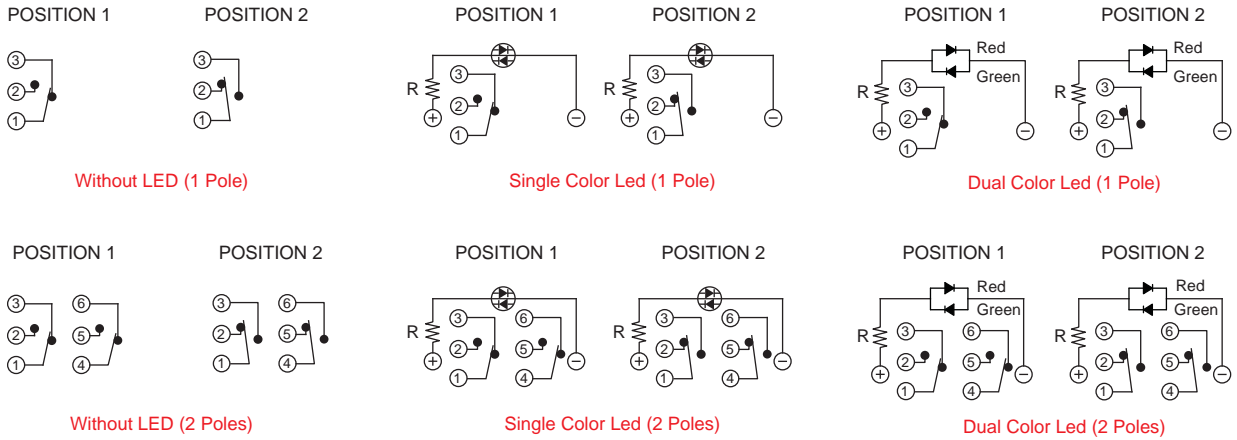

BODY TYPE

A0/C3 Body

D0 Body (Flat)

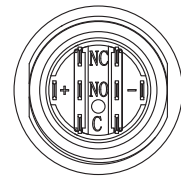
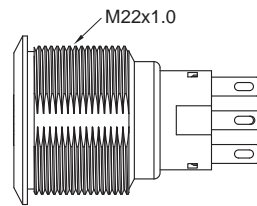
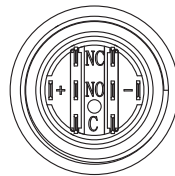
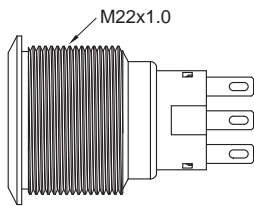

LIGHT TYPE

0 Without LED

E Ring (Moveable)

E3 Ring+Power logo

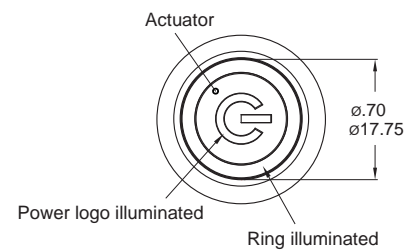
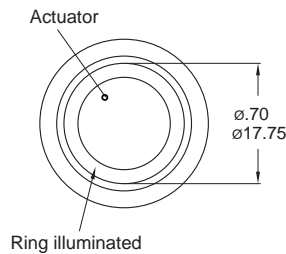
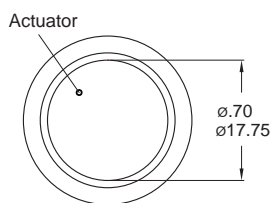

* Only for D0 body.

Wire (Flying lead Terminals)

* Wire=UL 3385, 18AWG, 300V (Black/Yellow/Green/Red/Purple)

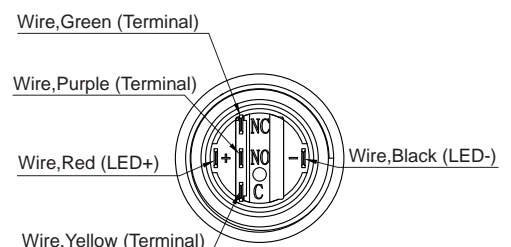
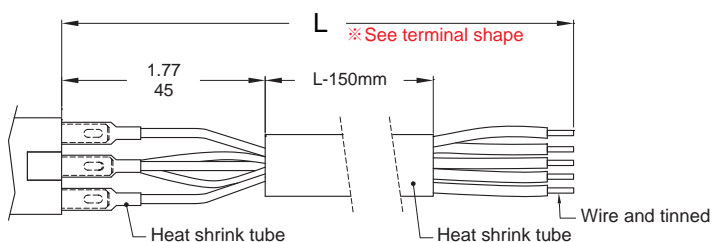

MPB22 Series

22mm Metal Pushbutton Switches

LIGHT TYPE

0 Without LED

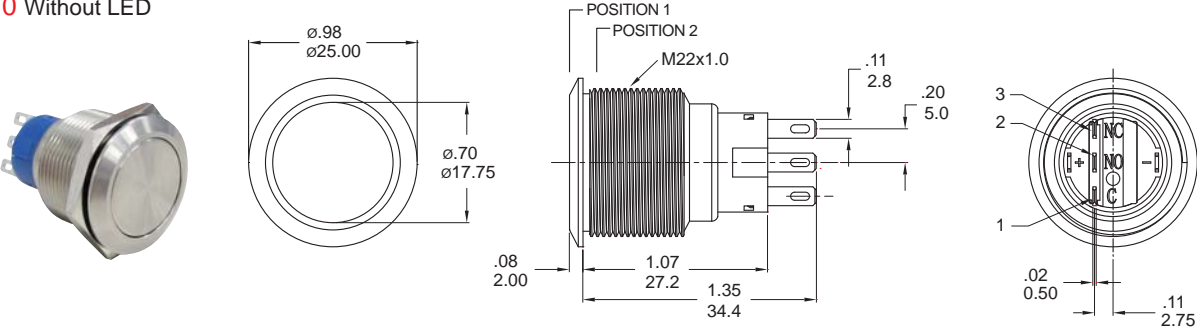

Part No. Shown : MPB22-A0F1 0-JQ

E Ring (Moveable)

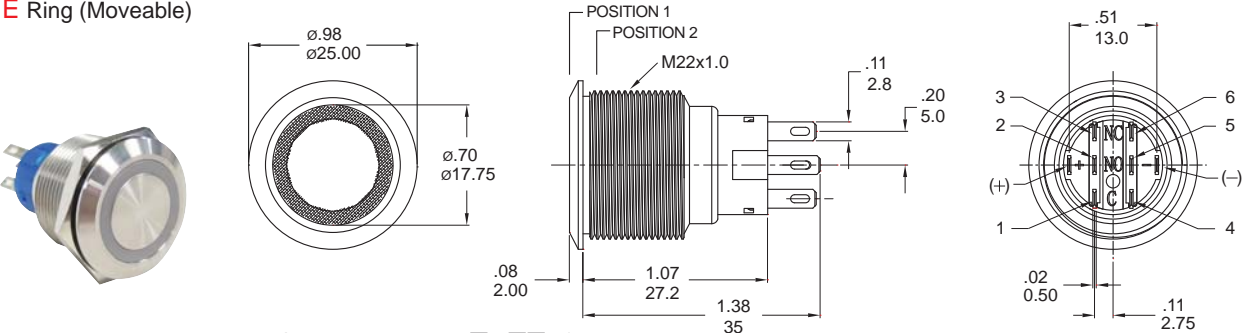

Part No. Shown : MPB22-A0F2 E-JQ

E3 Ring+Power logo

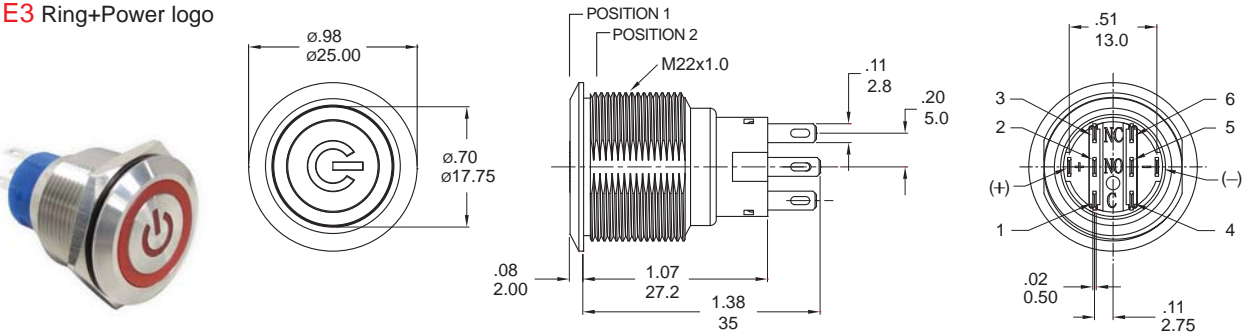

Part No. Shown : MPB22-D0F2 E3-JQ

ASSEMBLED VIEW

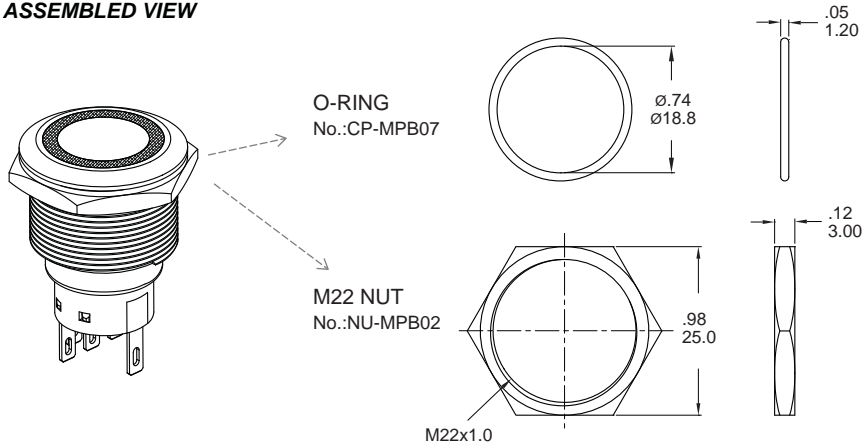

PANEL MOUNTING

Max. Panel thickness: 10.0mm[.39]

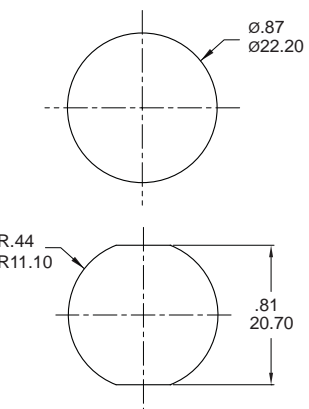

O-RING INSTALLATION

Proposal	In front of the panel	Behind the panel
Installation Diagram		