

SMD TYPE

STP-1197

STP 1197

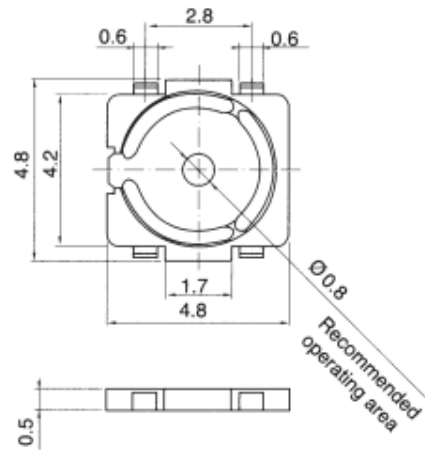
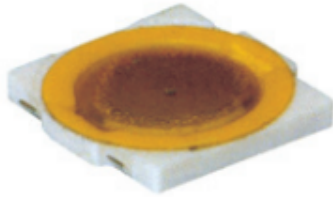

1. Rating 工作电流, 电压 : DC 12V, 50mA
2. Travel 移动 : $0.2 \pm 0.1\text{m/m}$
3. Operating Force 操作力 : $160 \pm 30\text{gf}$
4. Contact Resistance 接触电阻 : $100\text{m}\Omega$ Max.
5. Life Cycle 使用寿命 : 50,000 Cycles
6. Reel Package : 7,000PCS/REEL