

DIP TYPE

STP 1212

STP 1212

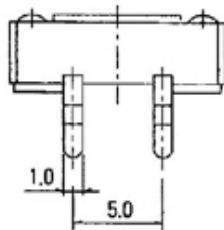
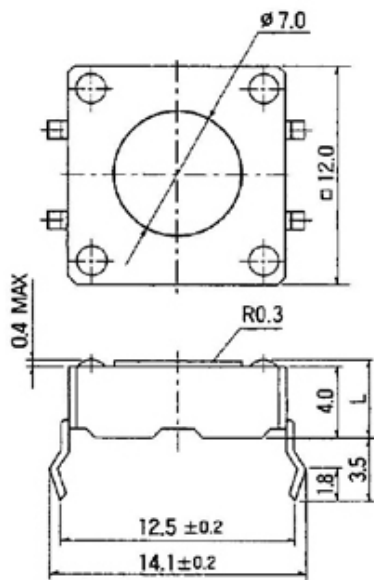

- 1. Rating 工作电流, 电压 : DC 12V, 50mA
- 2. Operating Force 操作力 :
160gf \pm 50gf
- 3. Travel 移动 : $0.25 \pm \begin{smallmatrix} 0.2 \\ 0.1 \end{smallmatrix}$ mm
- 4. Contact Resistance 接触电阻 :
100m Ω Max.
- 5. Life Cycle 使用寿命 : 100K Cycles Max

| Model No. | Stem (L) |
|-----------|----------|
| STP 1212 | 4.3 |
| STP 1212A | 7.5 |