

SMD TYPE

STP-1152

STP 1152

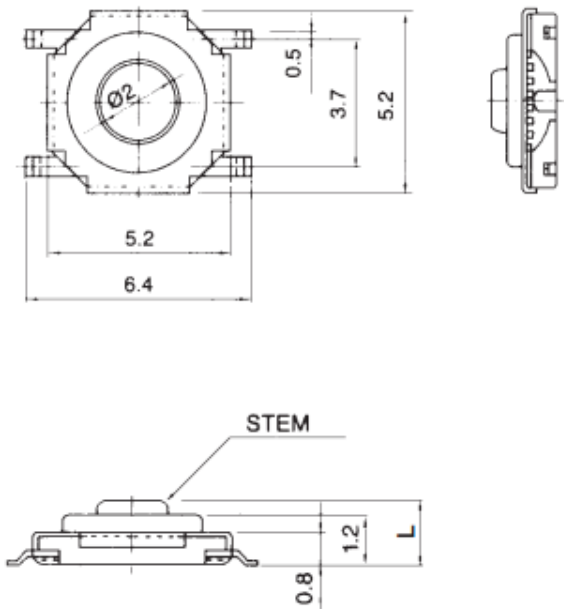

- 1. Rating 工作电流, 电压 : DC 12V, 50mA
- 2. Travel 移动 : $0.25 \pm 0.1\text{m/m}$
- 3. Operating Force 操作力 : $160 \pm 30\text{gf}$, $250 \pm 50\text{gf}$
- 4. Contact Resistance 接触电阻 : $100\text{m}\Omega$ Max.
- 5. Life Cycle 使用寿命 : 100,000 Cycles
- 6. Reel Package : 4,000PCS/REEL

Model No.	Stem (L)
STP 1152	1.5
STP 1152A	4.3

Stem : Metal, Plastic