



SPECIFICATIONS

RATING : 1th 5A/250VAC. resistive load 3A/250VAC.

CONTACT RESISTANCE : 50mΩ MAX.@1A 12VDC. (initial value)

INSULATION RESISTANCE : 1,000MΩ MIN at 500VDC.

DIELECTRIC STRENGTH : 2,000V RMS@sea level. (initial value)

OPERATION TEMPERATURE : -20°C to 55°C.

MECHANICAL LIFE : Momentary 1,000,000 cycles

Lock 500,000 cycles

ELECTRICAL LIFE : 50,000 make-and-break cycles at full load.

TORQUE : 0.3~0.5Nm.

OPERATION PRESSURE : 1Pole 2.5±1N / 2Poles 3.5±1N

TRAVEL : ABOUT 3.2mm.

INGRESS PROTECTION : IP65

MATERIALS

BEZEL : PC

BASE : PBT(UL 94-V0) & PC(UL 94-V2)

ACTUATOR : PC & POM.

INNER ASSEMBLY : POM. / PA66.

SPRING : Stainless steel.

SEALING : Silicone.

O-Ring : Silicone.

TERMINAL / CONTACT : Brass, silver plated.

HEX NUT : PC.

HOW TO ORDER

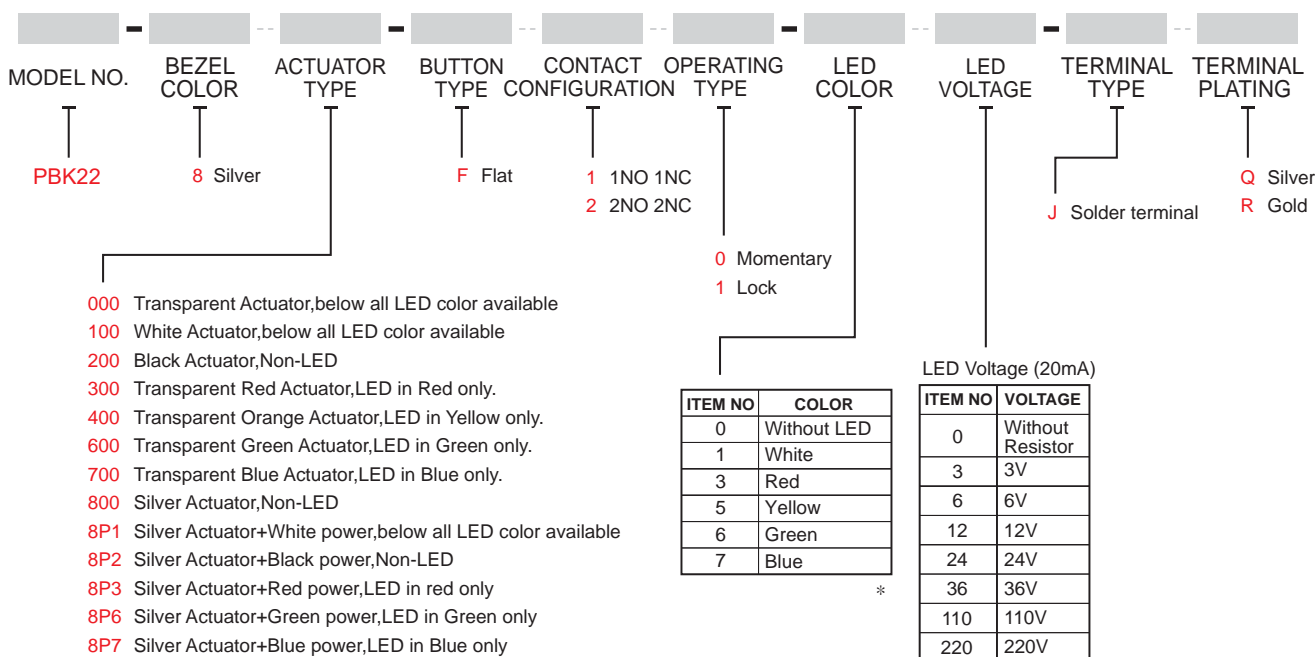

* Except standard color, for other colors information please consult sales representativity.

EXAMPLE:

PBK22-8000-F10-□-JQ
LED voltage
LED color

PBK22-88P1-F10-□-JQ
LED voltage
LED color



CIRCUIT

SINGLE POLE

Without LED

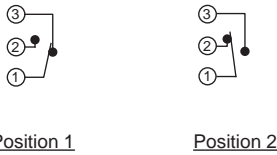

Single Color LED

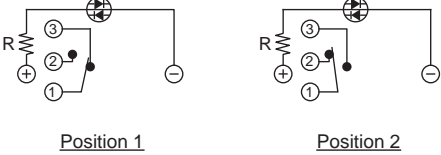

DOUBLE POLE

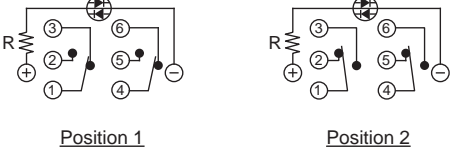
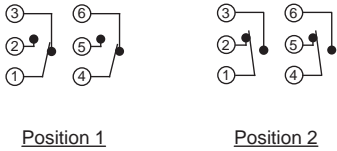

ACTUATOR OPTIONS

00

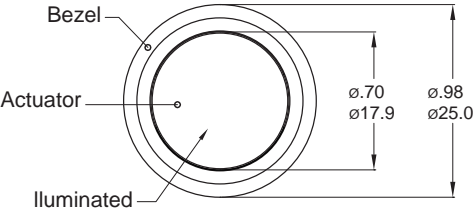

8P Power

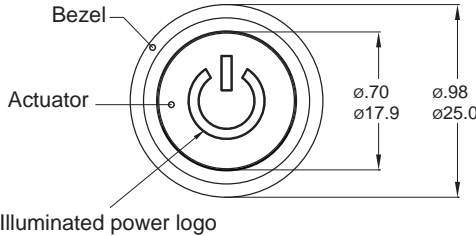

DIMENSION

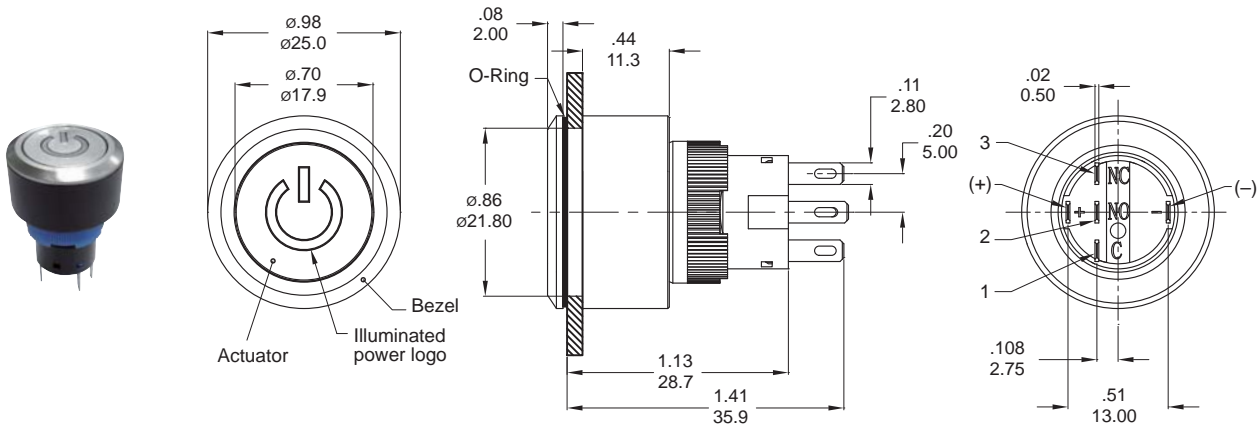

Model name. PBK22-88P1-F10-112-JQ

PANEL MOUNTING

Panel thickness:
.24inch(6.0 mm)MAX.

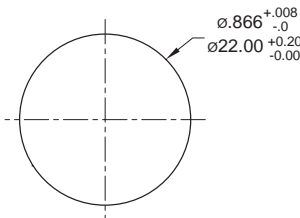

O-RING INSTALLATION

Proposal	In front of the panel
Installation Diagram	