



### SPECIFICATIONS

**RATING** : 2A/36VDC.

**ELECTRICAL LIFE** : 100,000 Make-And-Break cycles at full load.

**INSULATION RESISTANCE** : 1,000MΩ Min. at 500VDC.

**DIELECTRIC STRENGTH** : 2,000V RMS@sea level.

**CONTACT RESISTANCE** : 50mΩ Max.@ 1A/12VDC(Initial value)

**OPERATION TEMPERATURE** : -20°C~+70°C

**TRAVEL**: About 2.3mm.

**OPERATION PRESSURE** : 4.5N±1.5N

**INGRESS PROTECTION** : IP67(In house test)

**TORQUE** : 11.5 kgf · cm

※CAP Keeps same high.

### MATERIALS

**BUSHING** : Aluminum alloy, Anodized.

**BASE** : Nylon 6/6.

**ACTUATOR** : POM.

**CAP** : PC, Aluminum alloy, Anodized.

**SPRING** : Steel.

**SEALING** : Silicone.

**O-Ring** : Silicone.

**TERMINAL** : Brass, Coin silver, Gold flash plated.

**CONTACT** : Brass, Coin silver, Gold flash plated.

**NUT** : Brass(Nickel Plated).

## HOW TO ORDER

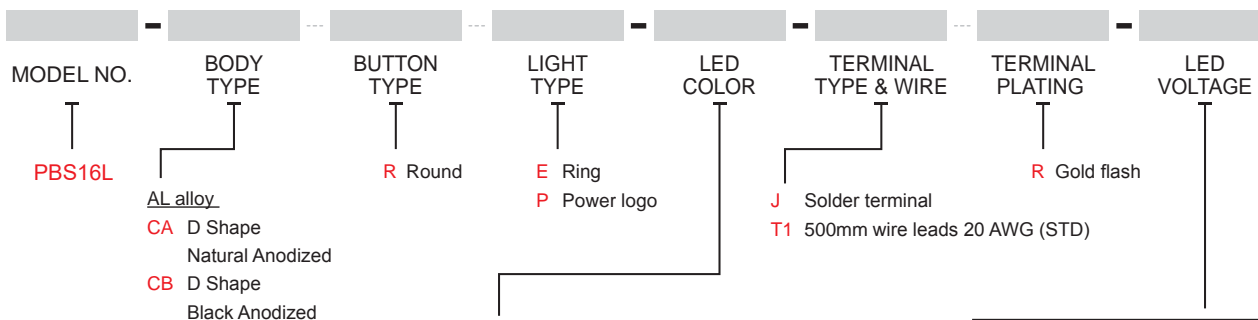

ITEM NO	COLOR
Single Color LED	
00	Without LED
01	White
03	Red
04	Orange
05	Yellow
06	Green
07	Blue
Dual Color LED	
36	Red+Green
37	Red+Blue
71	Blue+White

\*

※ Current limiting resistor is required to limit LED forward current to 20mA.

※ OFF=Without light  
ON=LED Blue light  
Ex : 07

※ OFF(Red);ON(Green)  
Ex : 36

Resistance (About LED Voltage)	
3V	LED Input Voltage 3VDC (Without Resistance)
6V	LED input 6 VDC,180Ω
12V	LED input 12 VDC,470Ω
24V	LED input 24 VDC,1000Ω

※ ohms value of resistance  
tolerance: ±5%

\* Except standard color, for other colors information please consult sales representativity.

EXAMPLE:  
PBS16L-CARE-00-JR-0 (Without LED)

PBS16L-CARE-□-JR-□V  
LED voltage  
LED color



# PBS16L Series

16mm Metal Pushbutton Switches(LOCK)



## ▼ CIRCUIT

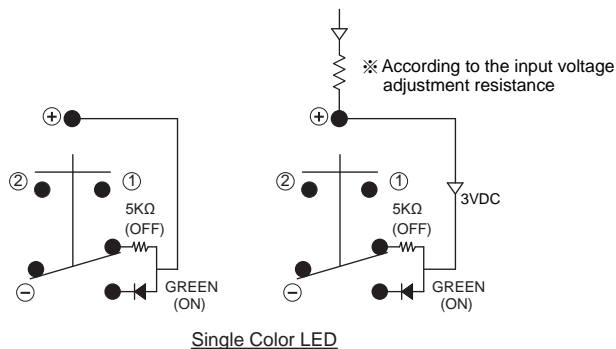

Note: Push-OFF, Without light  
Push-ON, LED Green light(Latching)

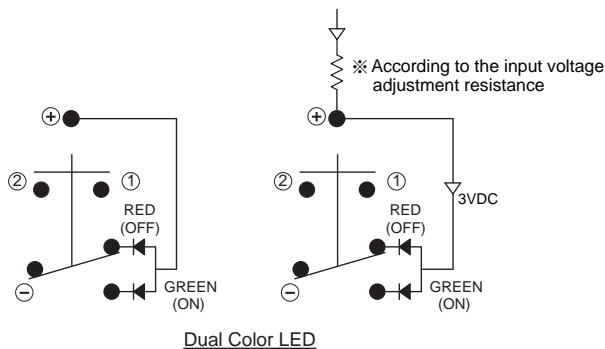

Note: Push-OFF, LED Red light  
Push-ON, LED Green light(Latching)

## ▼ BODY & BUTTON OPTIONS

CA / CB D Shape

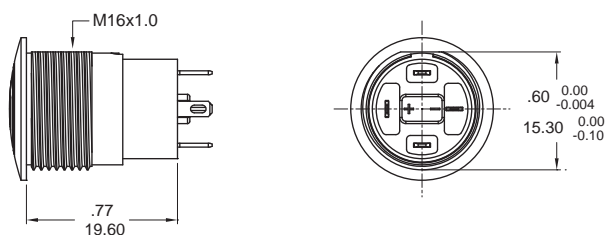

R Round



## ▼ LIGHT OPTIONS

E Ring

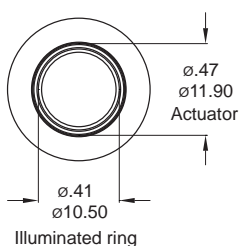

P Power logo

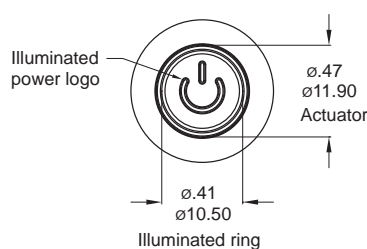

## ▼ DIMENSION

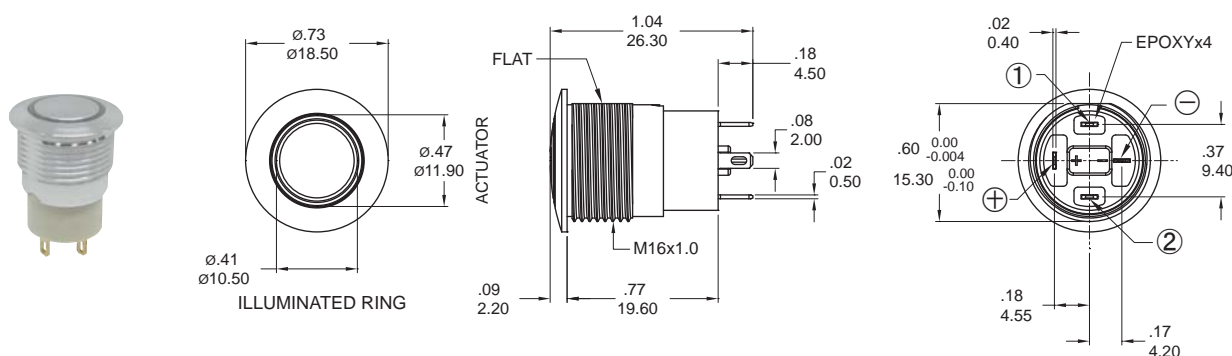

Model name. PBS16L-CARE-07-JR-3V



### ▼ WIRE

**T1** 500mm wire leads 20 AWG

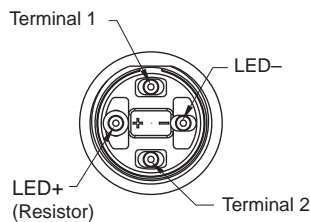
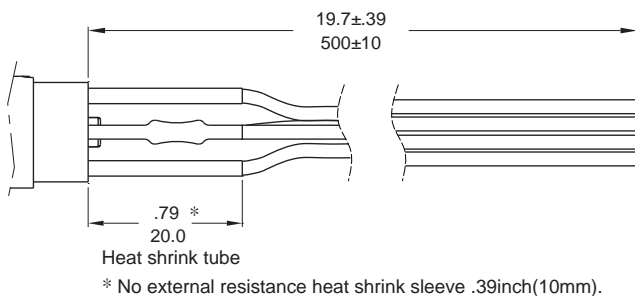

Wires:

Black wire - Terminal

Red wire - LED (+) Positive

Green wire - LED (-) Negative

\* No Illumination: Black Wire - Terminal

\* Please consult sales for additional wire options.

### ▼ PANEL MOUNTING

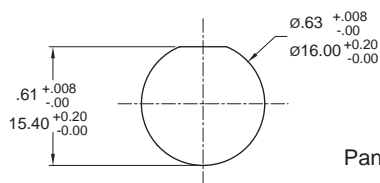

### ▼ HARDWARE

\* Standard hardware : 1 nut, 1 O-ring

\* For further information please consult sales representativity.

#### O-RING (Std.)

Model name. FCP-MP602

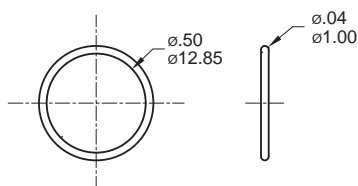

#### NUT (Std.)

Model name. MNU-PY01

